

ББС-1530

NO.	DESCRIPTION	NO.	DESCRIPTION
1	SCREW M6X30	23	SCREW M5X20
2	HANDLE	26	BEARING 6004-2RS
4	START ROPE	27	OIL SEAL
5	SCREW M5X22	28	OUTPUT SHAFT
6	TURNING KNOB	29	SCREW M6X60
7	KNOB SPRING	30	GEAR BOX
8	LEFT HANDLE COVER	31	STRAIGHT PIN $\Phi 5 \times 10$
9	NUT M5	32	PAPER PAD
10	BUMPER BLOCK	33	PINION
11	SCREW	34	STRAIGHT PIN $\Phi 6.5 \times 12.5$
12	FIXED PLATE FOR HANDLE	35	CIRCLIP FOR SHAFT $\Phi 19$
13	PASSIVE PLATE	36	PASSIVE GEAR SHAFT
14	TURNING KNOB SEAT	37	BEARING R12-2RS
15	TRIGGER CONTROL HANDLE	38	GEAR CASE COVER
16	CONTROL HANDLE TORSION SPRING	39	CIRCLIP FOR HOLE
17	TRIGGER TORSION SPRING	40	BEARING R10
18	TRIGGER	41	GEAR
19	SWITCH	42	GEAR SHAFT
20	RIGHT HANDLE COVER	101	GEAR BOX ASSEMBLY
21	SCREW ST3X8	102	OPERATION HANDLE ASSEMBLY
22	SCREW ST4X16		

RU-SO20141021

ENGINE FOR БС-1530

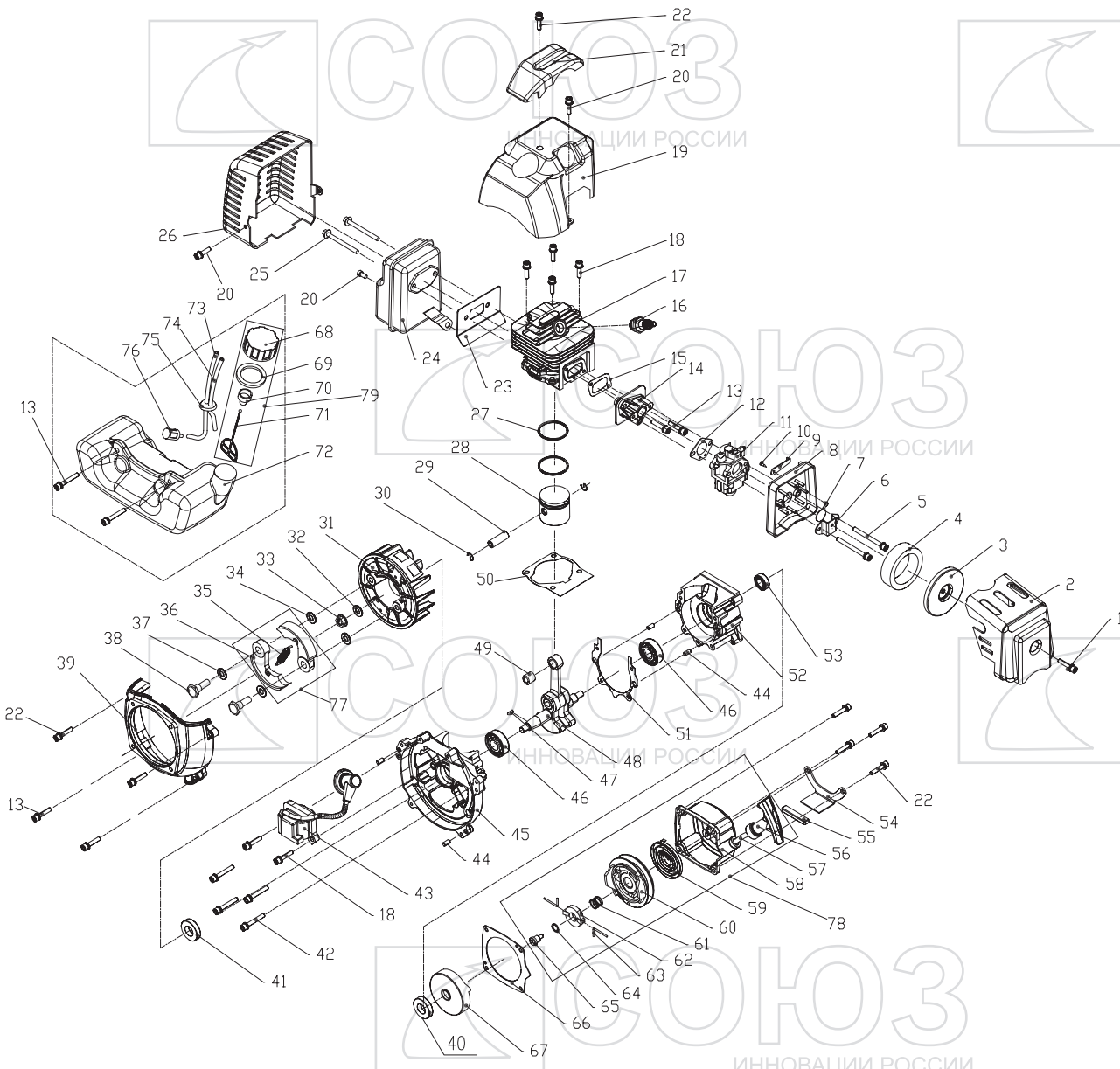

NO.	DESCRIPTION	NO.	DESCRIPTION
1	SCREW	41	SEAL
2	OUTSIDE COVER	42	BOLT
3	INSIDE COVER	43	COIL COMP
4	FILTER	44	CRANK CASE PIN
5	SCREW	45	LEFT CRANK CASE
6	BUFLER	46	BEARING 6202Z
7	CHOKE	47	KEY
8	INSIDE COVER	48	CRANK SHAFT
9	CHOKE HANDLE	49	NEEDLE BEARING
10	SCREW	50	CYLINDER GASKIT
11	CARBURETOR	51	CRANK CASE GASKET
12	GASKET	52	RIGHT CRANK CASE
13	SCREW	53	SEAL
14	ADMITTING PIPE	54	STAND
15	GASKET	55	RUBBER COVER
16	SPARK PLUG	56	START HANDLE
17	CYLINDER	57	ROPE
18	SCREW	58	START COVER
19	GUIDE COVER	59	RECOIL SPRING
20	SCREW	60	START ROPE REEL
21	COVER	61	FUEL TANK LID COMP
22	SCREW	62	STARTER WHEEL
23	MUFFLER GASKET	63	STARTER SHAFT
24	MUFFLER	64	RUBBER WASHER
25	SCREW	65	SCREW
26	MUFFLER COVER	66	START GASKET
27	PISTON RING	67	START REEL COMP
28	PISTON	68	FUEL TANK LID
29	PISTON PIN	69	GASKET
30	RING	70	STOP PLATE
31	FLY WHEEL	71	CHAIN
32	WASHER	72	FUEL TANK
33	NUT	73	FULE INLET PIPE
34	WASHER B	74	FULE OUTLET PIPE
35	EXPANDER SPRING	75	PLUG
36	EXPANDER	76	FULE FILTER
37	WASHER	77	EXPANDER COMP
38	SCREW PIN	78	STARTER
39	FAN COVER	79	FUEL TANK LID COMP
40	WASHER		

RU-SO20141021